



## 33 Saturn Close

, Southampton, SO16 8BD

**Offers in excess of £230,000**

We are delighted to bring to the market this 2 bed mid terraced property situated in the sought after area of Lordshill. Featuring two double bedrooms, lounge, refurbished kitchen and bathroom, a brand new boiler (installed Jan 2023), conservatory, garden, rear driveway with security gates and a garage.

- Off Road Secure Parking
- Garage
- Conservatory
- Close to Local Amenities
- Refurbished Bathroom
- Refurbished Kitchen
- New Boiler



Please contact our ROK Marsh Office on 02393233267 if you wish to arrange a viewing appointment for this property or require further information.





Floor Plan

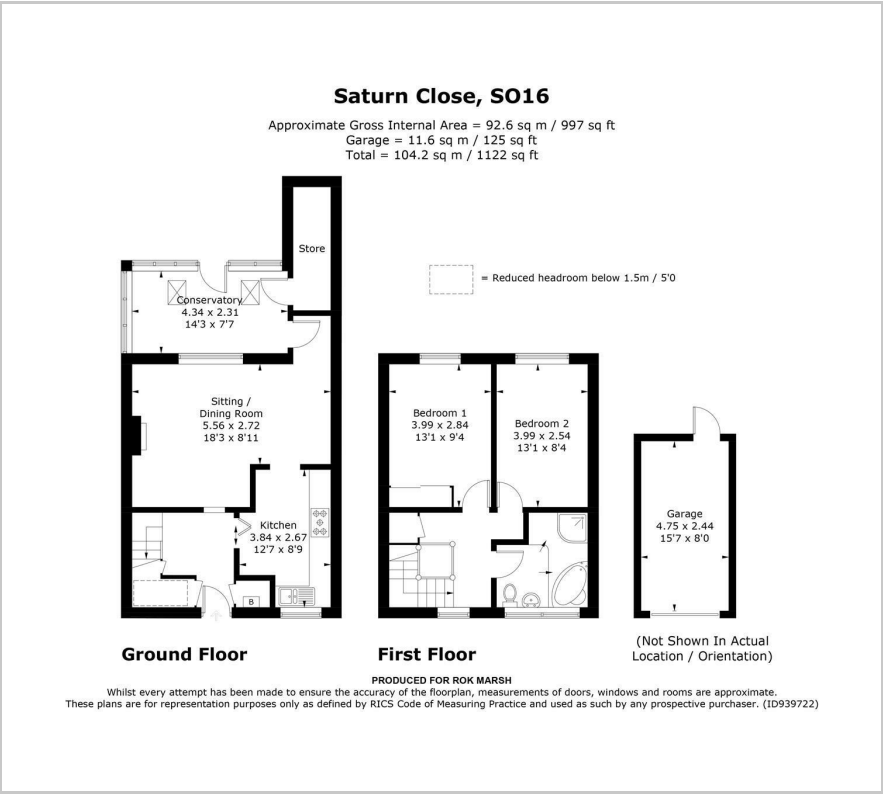

Area Map



Energy Efficiency Graph



These particulars, whilst believed to be accurate are set out as a general outline only for guidance and do not constitute any part of an offer or contract. Intending purchasers should not rely on them as statements of representation of fact, but must satisfy themselves by inspection or otherwise as to their accuracy. No person in this firms employment has the authority to make or give any representation or warranty in respect of the property.